

Mobile Garden at East Wick

Background to the Mobile Garden

The Mobile Garden is temporary garden and growing space for local residents, schools and businesses on development land within the future neighbourhoods. To date the Mobile Garden at Chobham Manor has been providing a welcoming, practical, temporary garden and growing space for local residents and providing activation of a space on a key route into the Park from the Leyton and Chandos area.

LLDC have secured a planning permission for the Mobile Garden on development parcel 5.3 for 5 years.-removal of the turning circle and utility diversions by EWS are required to create the currently proposed footprint.

As part of the MakeShift feasibility for Clarnico Quay the Mobile Garden is to be considered as part of their design process including location within the site and layout.

1. Aims and objectives of the garden at East Wick:

- To create a shared, accessible, vibrant and free community space.
- A place of integration and diversity for existing and new residents in and around Queen Elizabeth Olympic Park – a meeting place for all.
- To connect local residents with public/ outdoor spaces, with the aim of providing leisure opportunities and improving health and wellbeing.
- To deliver a range of activities such as gardening, social space to relax in, formal growing activities, play, informal learning and training which appeals to all and at various entry levels.
- A space for engagement for East Wick residents and provides a connection with the future public spaces in EWS.
- Acts as a visual marker raising the local profile and brand for EWS and Clarnico Quay.

2. Area, location and duration

- To be determined during the design process but either 5.3 or on the lower level.
- Site area to be a minimum of 1000sqm to allow for the existing garden items to be accommodated- list attached
- The garden at Chobham Manor needs to move by 16th February 2018.
- Garden to be in situ to align with the MakeShift term.

3. Design and planning permission

- A planning application has been submitted for 1000sqm on parcel 5.3, determination is pending- 17/00012FUL
- The application seeks permission for the boundary treatments as per the drawings in the appendix. Drawings submitted showing the internal arrangement are purely indicative.
- The Chobham Manor garden design has taken its inspiration from the garden city concept and therefore consists of different zones for example the town square, growing fields, glut fields and school.

- The East Wick submitted application is loosely aligned with the concept.
 - The initial concept is flexible and is open to suggestions to fit in with a changing concept alongside MakeShift.
 - The concept of the garden being mobile and temporary needs to be maintained.
 - The focus of the garden is on productive planting (about 70% of the planting) and perennial plants and shrubs.
 - Other key design considerations include:
 - Creation of a garden/growing space- critical mass of beds
 - Grouping of the planters
 - Fully accessible across the whole site- this may require enabling works to level areas
 - Flat/level surface
 - DDA compliant accessible entry / exit routes to garden
 - Ability to separate from the rest of the site as required
 - Places to sit and enjoy the garden
 - Areas of shelter including space for welfare and training
 - Visual impact/quality of the design
 - Importance of re use within the garden
 - Consideration of light, overshadowing and wind impact
 - Access to water for day to day management

4. Key components of the garden

- **Raised Beds and other growing structures** including vertical growing structures and polytunnels for growing fruit, vegetables and other plants for harvesting; to enable use by varying abilities and heights.
- **Flexible open space** –for picnicking, informal events, Cobb oven, BBQ.
- **Banqueting area** – for eating the produce from the garden, or for community use to encourage a wide variety of uses and users –to include a BBQ/ fire pit area.
- **Playable areas** – interactive, robust elements to cater for a wide range of children’s ages.
- **Structures:** indoor shelter, rain and shade cover with seating areas, bike workshop space.
- **Shed:** for tool and equipment storage

5. Garden infrastructure

Below is complete of items linked with the garden

Item	NR	Unit
Boundary treatment and signage	-	-
Timber picket fence, 1.5m high	120	m
5m wide double leaf gates, to match timber picket fence.	1	nr
2m wide double leaf gates, to match timber picket fence.	2	Nr
Site signage boards	2	Item

Waymarkers and signage	1	item
Site Furniture		
Straight coloured benches Dimensions: 202x42x45cm	6	No
Curved colour benches. Dimensions 265x90x50cm	2	No
Picnic benches- steel frame with timber insert. Dimensions 202x42x45cm	6	No
Picnic tables steel frame with timber inserts. Dimensions 202x102x75cm	3	No
1000Litre ICB water container Dimensions 110x100x100cm	12	No
Waste basket 58x58x72cm	1	No
Low raised planters 90x90x30cm	82	No
Mid height planters 100x120x60cm	84	No
High raised planters 100x120x50cm	12	No
Rectangular planter 200x100x70cm	4	No
Bike rack 5 hoops galvanized cycle rack-bolted to two sleepers.	2	Items
Compost box 120x100x110cm	5	Item
Cob oven 400x600	1	Item
Cob oven shelter 245x265x230	1	Item
BBQ unit 100x100x100cm	1	Item
Sand play unit	1	Item
Steel frame wire mesh planters 100x100x110cm	8	Item
Structures		
Welfare cabin container 945x300x260	1	Item
Tool store container 605x245x260cm	1	Item
Polytunnel tunnel including trestle preparation tables. 630x455x300	1	Item
Shed 186x205x270cm	1	Item
Stage/shelter 680x400x420cm- needs maintenance	1	item
Shed on wheels	1	Item

*numbers to be confirmed ** as built drawings and H&S file available

6. Expected activity delivered at the garden- based on current activity

- General open access and social space (open during daylight hours).
- 60 hours of programmed activity per a month by a community gardener or 3 days a week of community gardener delivered activity.
- Community events linked to growing, health and wellbeing.
- Regular school activity in particular targeting Mossbourne Riverside Academy, Bobby Moore Academy, Gainsborough School and Chobham Academy.
- Informal training opportunities- skills based and demand led.
- Bespoke activities for East Wick phase 1 residents.

- Development of gardening group to look after/manage the community growing spaces in phase 1.
- Volunteer activities.
- Weekly free bike workshops.

7. Operator

- It is intended that the Garden will be operated by Our Parklife.

Proposal for Makeshift

Through the Clarnico Quay design process the physical integration of the Mobile Garden into the proposals should be explored.

In turn there would be an updated planning application for Mobile Garden either to align boundary treatments or to integrate Mobile Garden within the Clarnico Quay planning application.

1. Proposed operating arrangements

- Lease/contractual arrangement between Our Parklife and MakeShift
- See operator spec for more details

Also to note; LLDC has funding available to contribute to supporting the garden in terms of maintenance and programme activity.

Appendix- Elevation

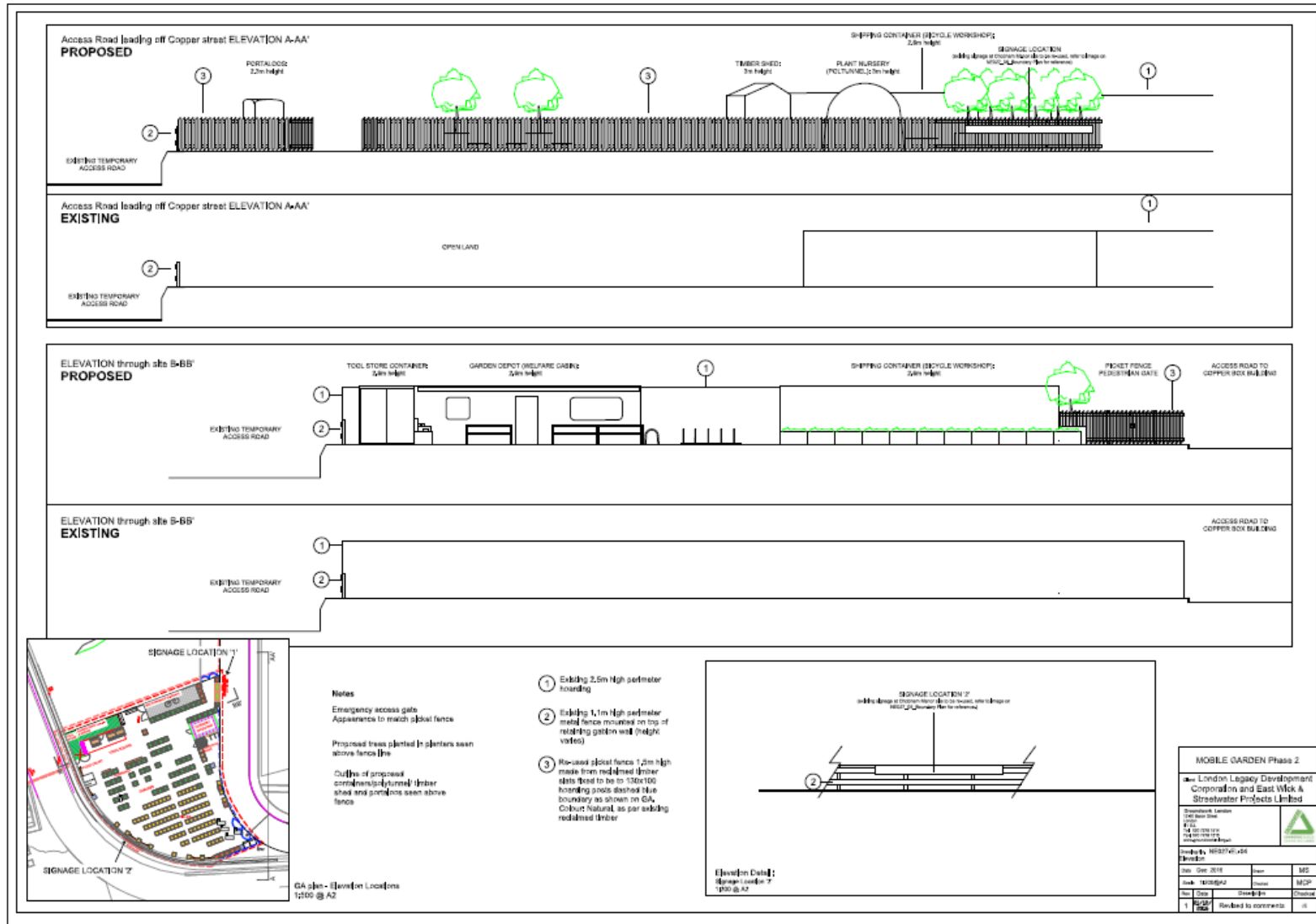

Boundary treatments

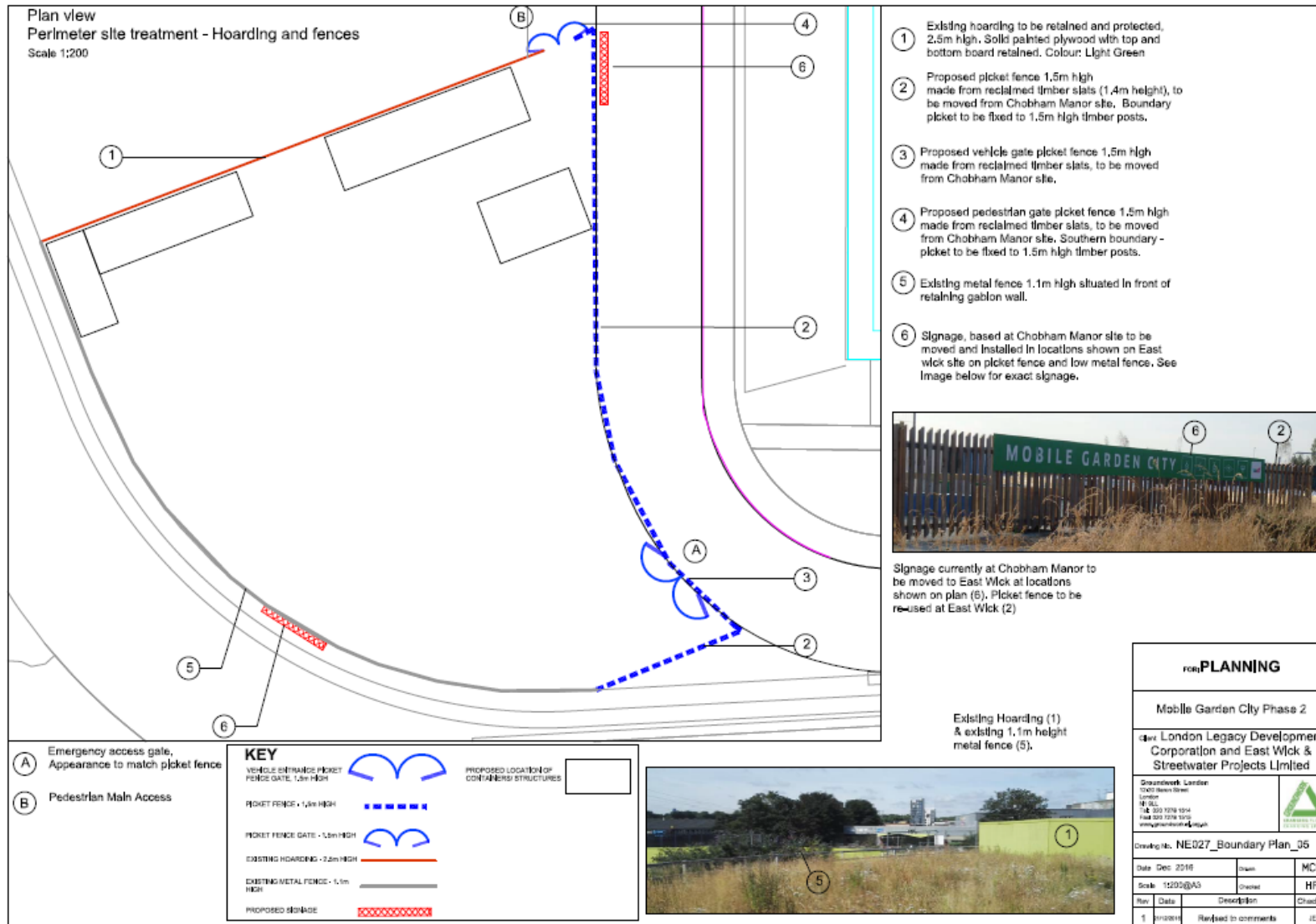

General internal arrangement

